

Court

Plan 51912 | 1 Story | 3-4 Bedrooms | 2-3 Bathrooms

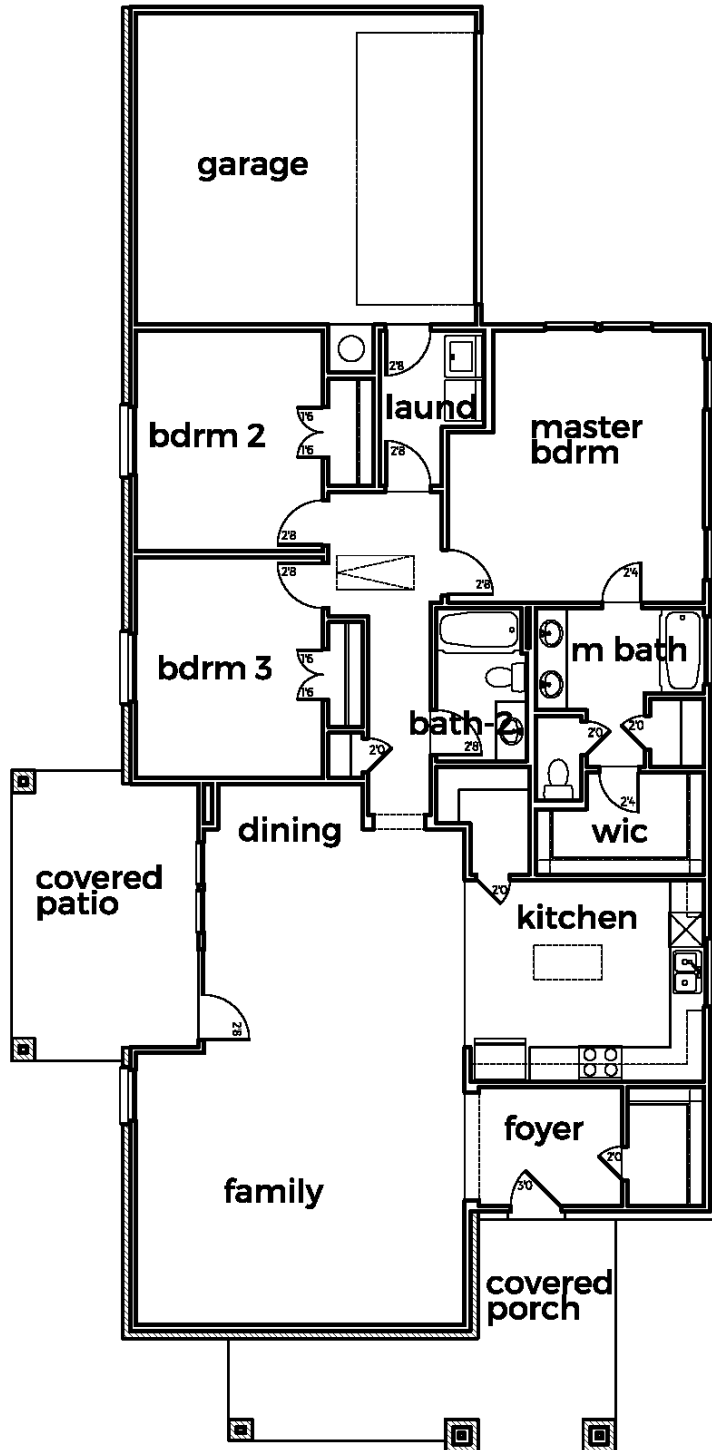

Options Available:

- Box window at bedroom 2 and 3
- Box window at master bedroom
- Extended covered patio
- Powder by foyer
- Master bathroom with shower
- Master bathroom with shower & linen closet
- Fixed French doors at dining room
- Apartment above garage



 pacesetterhomestexas.com

© Pacesetter Homes, LLC. Unauthorized use of this plan is a violation of the U.S. Copyright Act Title 17 of the U.S. Code. Floorplans and Elevations are subject to change without notice. The Floor plans and elevations represented, are artistic concepts. The actual construction plan may differ in features, dimensions, and colors offered. All square footage is approximate living area. Your Pacesetter representative will be happy to provide specific and current details.

Court

Plan 51912 | 1 Story | 3-4 Bedrooms | 2-3 Bathrooms



Court A – Texas Vernacular



Court B - Craftsman



Court C – Modern Prairie



 pacesetterhomestexas.com

© Pacesetter Homes, LLC. Unauthorized use of this plan is a violation of the U.S. Copyright Act Title 17 of the U.S. Code. Floorplans and Elevations are subject to change without notice. The Floor plans and elevations represented, are artistic concepts. The actual construction plan may differ in features, dimensions, and colors offered. All square footage is approximate living area. Your Pacesetter representative will be happy to provide specific and current details.

